



**JOHN  
GEORGE**

Delivering Performance Since 1725

johngeorge.co.uk  
sales@johngeorge.co.uk

Wholesale distributors to merchants  
in the building, roofing, fencing and agricultural trades

**Product  
Information**

# Square/Round Adapter

Designed to connect a combination airbrick or telescopic underfloor vent to a 4" round pipe.

The adapter fits directly onto the bottom of the telescopic underfloor vent and can be easily cut down between the pre-moulded cut lines to fit the combined airbrick.

Also known as a remote void ventilator.



## Installation

1. Fit to a combination airbrick by simply cutting the front section off between the pre-moulded cut lines and pushing on to the back of the brick (see diagram A).
2. Fit to a telescopic underfloor vent by pushing the adapter into the back, allowing a 4" soil pipe/drainage pipe to be fitted to the adapter (see diagram B).
3. Bricklaying should continue as normal although care should be taken to keep the airflow passage clear of mortar droppings.
4. If the square/round adapter is to be built in above DPC, a suitable cavity tray should be fitted over the ventilator.
5. Should be used in conjunction with a combination airbrick or a telescopic underfloor vent.

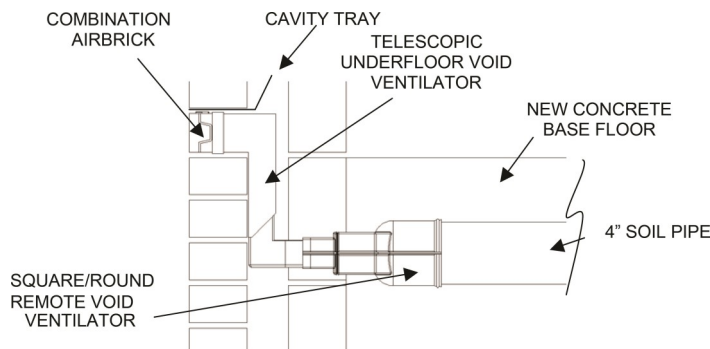
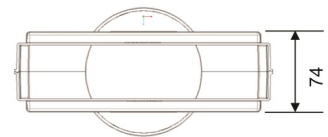
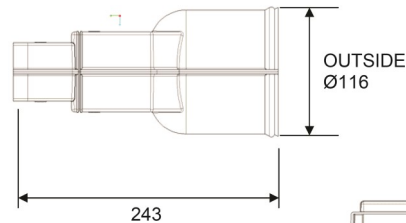
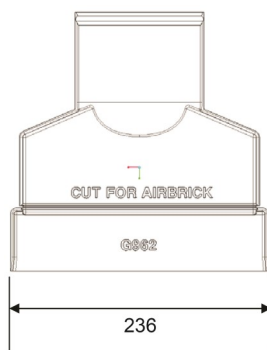
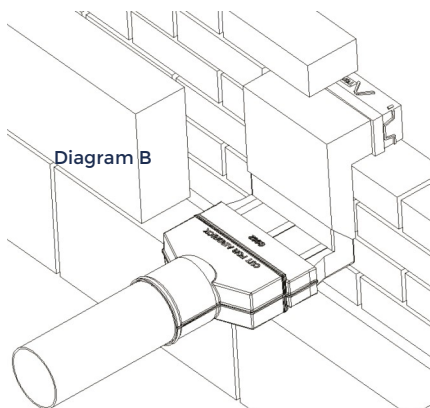
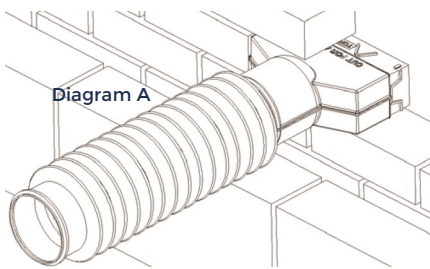
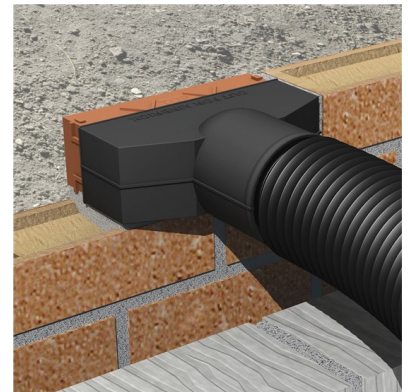

FITTING SITUATION  
WHEN A CONCRETE BASE  
HAS BEEN LAID AND THE  
VOID BELOW A BEAM AND  
BLOCK FLOOR STILL  
REQUIRES TO BE  
VENTILATED.

**WEST:**

Tel: 01275 335810 Fax: 01275 349203

**CENTRAL:**

Tel: 0118 941 1234 Fax: 0118 945 1059

**EAST:**

Tel: 01268 663130 Fax: 01268 663131